



**EBARA**

# 3' Series Stainless Steel Centrifugal Pumps

Model **3M, 3LS**  
2 pole versions

**3M4, 3LS4**  
4 pole versions



*Featuring Ebara's patented hydro forming process to obtain a true volute shaped casing in a stamped stainless steel pump.*

# Ebara 3' series stainless steel pumps

These stainless steel pumps feature a patented one piece volute casing that is produced using an advanced computer controlled plasma stamping system developed by Ebara.

Total quality control is ensured during manufacture, resulting in products of a consistent high standard.

The volute casing combined with the smooth surfaces of stamped stainless steel results in high efficiency, low NPSH requirements and low noise.

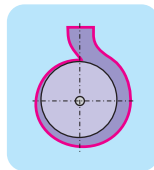
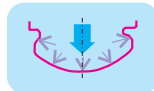

The unique manufacturing process and design provides a cost effective alternative to traditional cast iron pumps

Suitable for many applications:-

- Industrial, commercial and agricultural applications
- Water supply      • Irrigation      • Cooling towers
- Booster sets      • Washing plants or machines
- Air conditioning systems      • Heat exchangers
- For the pumping or boosting of rust free water

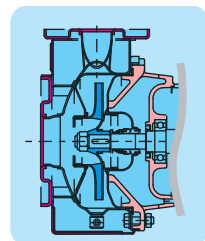

The centre line discharge and foot support under the casing ensure maximum resistance to misalignment and distortion from pipe loads.



All stainless steel wetted components for rust free water and increased corrosion resistance.

The back pull-out construction permits the disassembly and overhaul of the impeller, shaft and bearings without removal of the suction or discharge piping, or pump casing.

Economical extended motor shaft version in 304 stainless steel

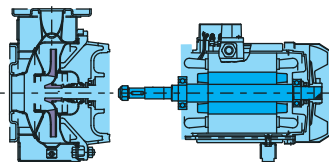

Stub shaft version in 316 stainless steel, with SiC/SiC seal. Uses standard motors.

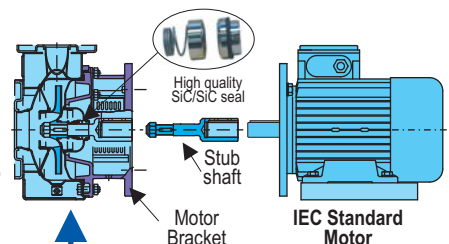

## Specifications

	3M / 3M4			3LS / 3LS4							
Discharge Ømm	32	40	50	32	40	50	65		80		
Nominal Impeller Diameter mm	-125 -160 -200	-125 -160 -200	-125 -160 -200	-125 -160 -200	-125 -160 -200	-125 -160 -200	-125 -160 -200	-125 -160 -200	-250	-160	-200 -250
Casing	Stamped 304 SS			Stamped 316L SS				Cast 316 SS			
Impeller	Stamped 304 SS			Stamped 316L SS			Cast 316 SS				
Back Cover	Stamped 304 SS			Stamped 316L SS				Cast 316 SS	Stamped 316L SS	Cast 316 SS	
Mechanical Seal	Carbon/Ceramic/NBR #			Silicon Carbide/ Silicon Carbide/ Viton <small>with anti rotation device</small>							
Casing O’Ring	NBR #			Viton							
Motor Power	1.1~15.0 kW (2 Pole) 0.37~2.2 kW (4 Pole)			1.1~55.0 kW (2 Pole) 0.25~7.5 kW (4 Pole)							
MotorType	Extended shaft, aluminum frame, 3Phase only, IP55 enclosure.			Uses IEC standard frame motors. Normally supplied with standard IP55 motors. Can be supplied with single phase, special enclosure or specific brand motors on request.							
Max. Working Pressure	10 Bar			10 Bar							
Liquid Temperature	-10° to +90° C <sup>#</sup>			-10° to +110° C							
Standard	Dimensions to DIN 24255 , with DIN 24960 seal & DIN 2532 flanges for market interchangeability.										

#3M/3M4 can be fitted with optional high temperature or hard faced seals, with viton O'Ring.



## Performance curves

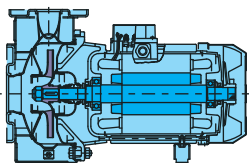

**3M**  
Extended motor  
shaft version

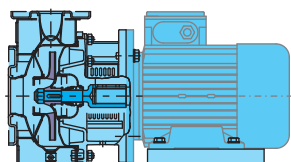
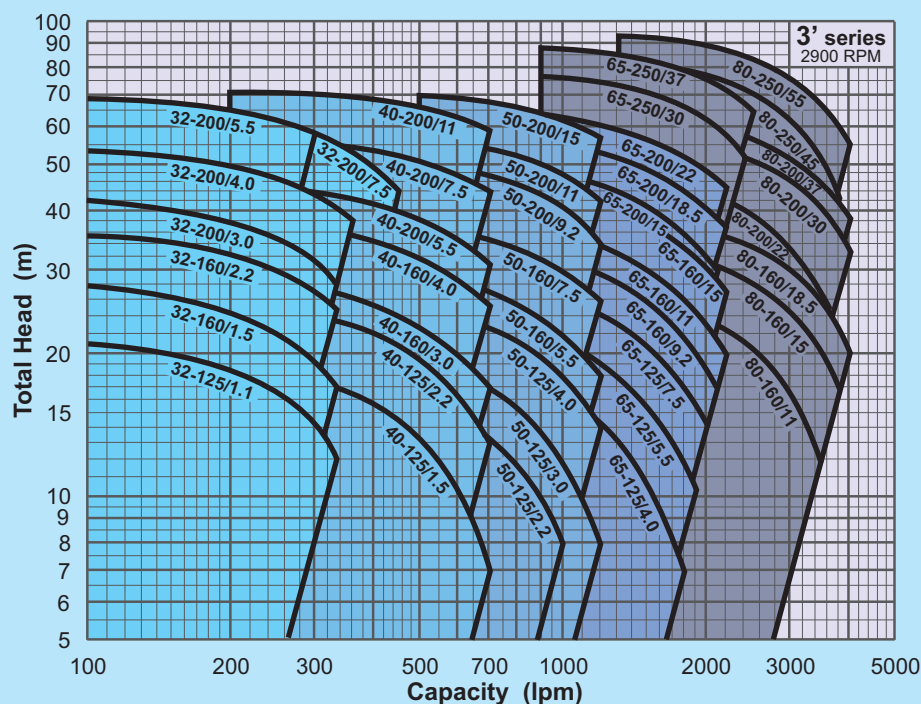

**3LS**  
Stub shaft  
version

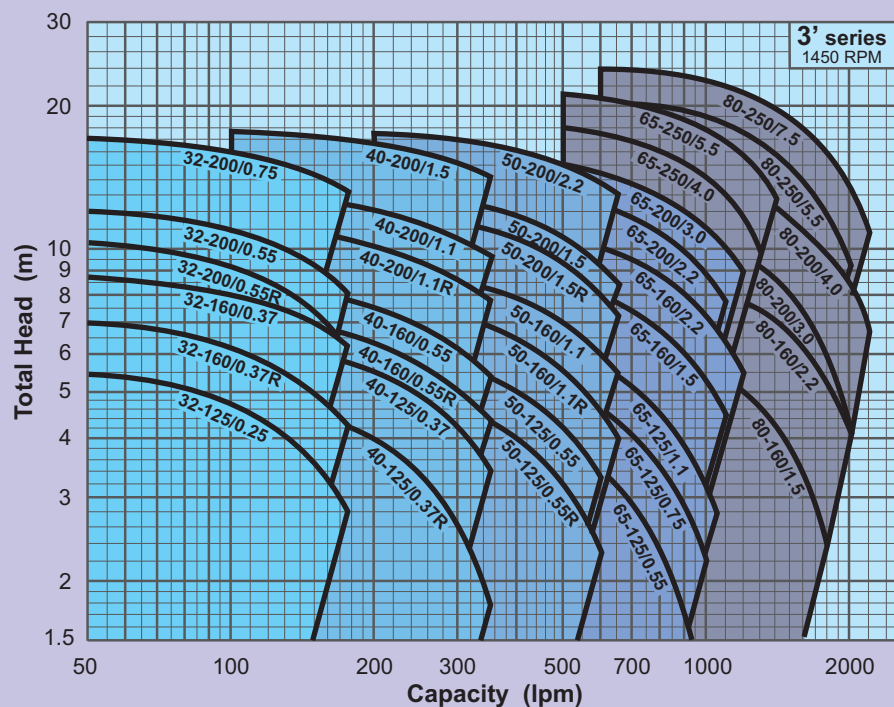

**3LSF**  
Pump end  
kit (without motor)



Cast casing



Refer to specification table opposite for details.

### Model Code

**3LS4 50 - 160 / 1.5 R**

Reduced Diameter Impeller (4 pole 3LS's only)

Motor Size kW

Nominal Impeller Diameter mm

Discharge Size Ømm

4 = 4 Pole speed (Blank = 2 pole version)

3M

Model: 3LS

3LSF

Extended motor shaft version, 304 Stainless Steel

Stub shaft version, 316 Stainless Steel

F = Pump end kit (without motor)

## Typical construction

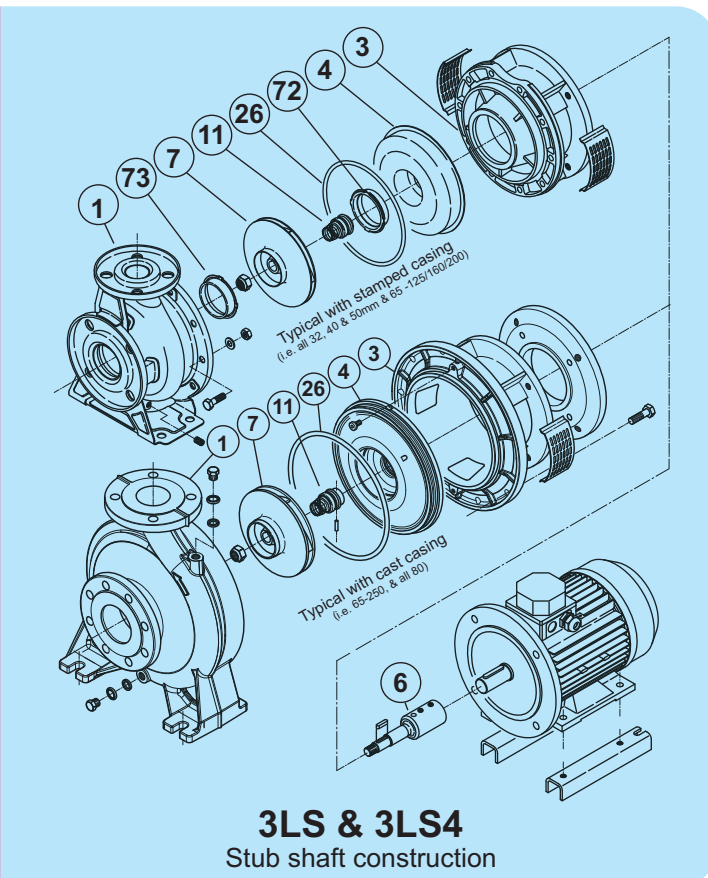
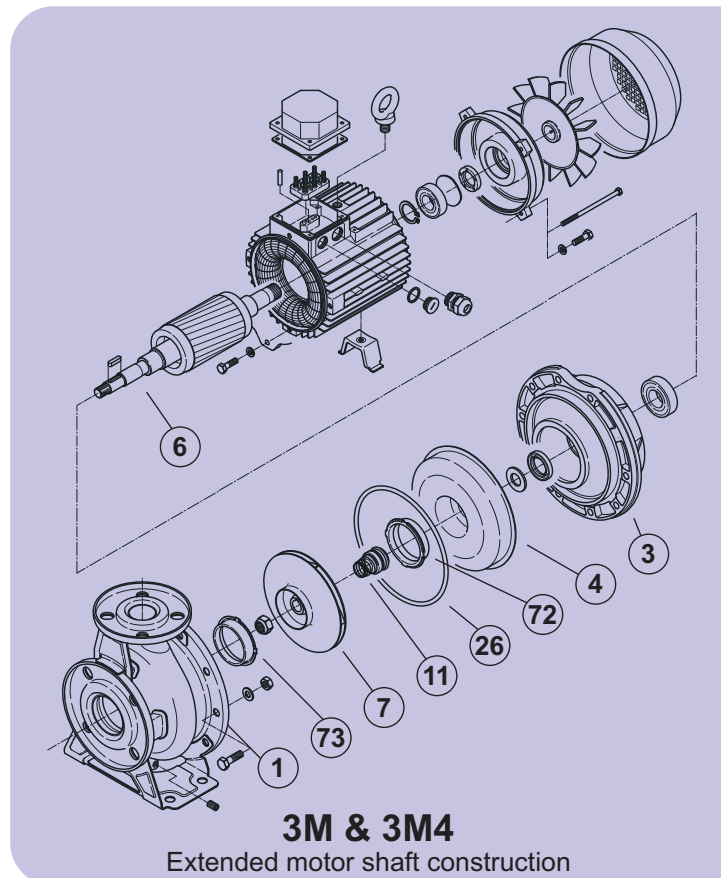

Item	Description	Item	Description	Item	Description
1	Casing	6	Shaft	26	O-ring (casing)
3	Motor Bracket	7	Impeller	72	Casing Ring (rear)
4	Casing Cover	11	Mechanical Seal	73	Casing Ring (front)

## Additional stainless steel end suction pumps

Smaller single or twin impeller pumps, and open impeller pumps are available. These models all feature Ebara's plasma stamped volute.

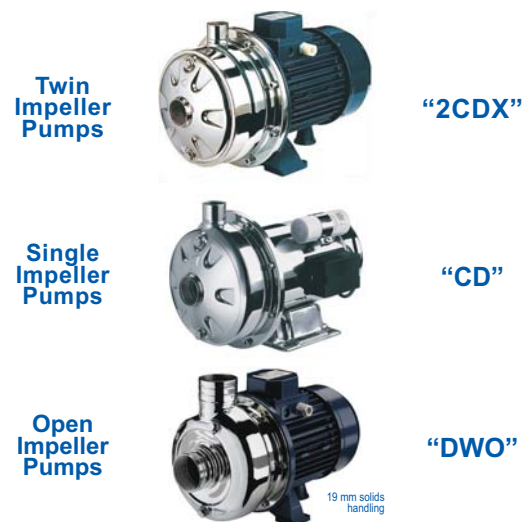
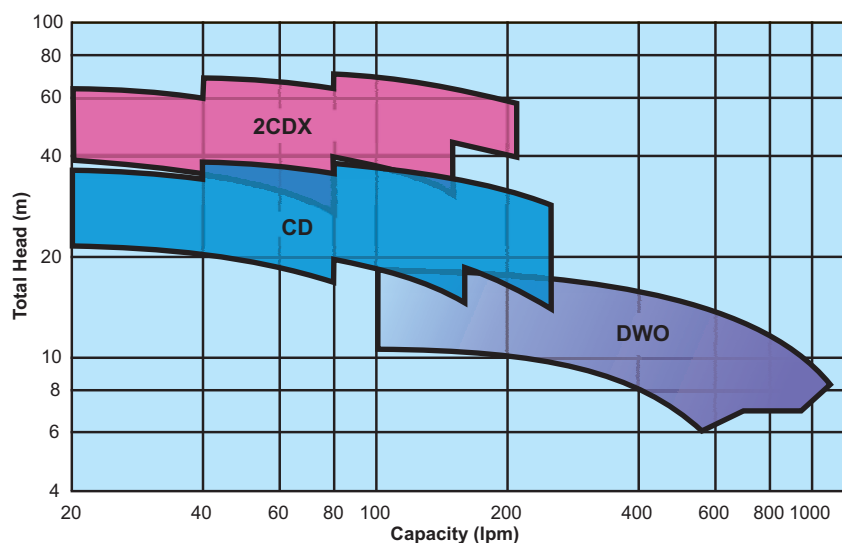

Specifications subject to change without notice

Dealer



**EBARA** PUMPS AUSTRALIA PTY. LTD.  
1 Jackstaff Court  
Bayswater North, Vic. 3153  
Ph: 03 9761 3033 Fax: 03 9761 3044

[www.ebara.com.au](http://www.ebara.com.au)